

PRASAR BHARATI
(BROADCASTING CORPORATION OF INDIA)
OFFICE OF THE ADDL.DIRECTOR GENERAL(E)(SOUTH ZONE)
ALL INDIA RADIO & DOORDARSHAN
SWAMI SIVANANDA SALAI,CHENNAI-600 005.

No.ADG(E)(SZ)/PUR/42/PORTA CABIN/2011-12

Date: 02-09-2011

1. DESCRIPTION:-

SEALED TENDERS ARE HEREBY INVITED FOR AND ON BEHALF OF THE PRESIDENT OF INDIA, FROM REPUTED FIRMS FOR THE SUPPLY, INSTALLATION, TESTING AND COMMISSIONING OF ONE PORTA CABIN AT VLPT PARVATHIPURAM OF ANDHRA PRADESH UNDER DMC VISAKHAPATNAM (AS PER THE SPECIFICATION ENCLOSED).

2).The tender shall consists of three part of bids namely

- i) **EMD:** As per clause 7 of this tender document E.M.D should be enclosed in a separate sealed envelope. Technical and Commercial bids will be opened only of those tenderers who have submitted the required E.M.D.
- ii) **Technical Bid:** Technical bid tender should contain the confirmation to the enclosed technical specifications. This should be submitted in a separate sealed envelope with "TECHNICAL BID" written on envelope along with the name of the material/work,date of opening.
- iii) **Commercial Bid:**The Commercial bid should contain the price bid and acceptance of the commercial terms and conditions of this tender documents.This should be submitted in a separate sealed envelope with "COMMERCIAL BID" written on the envelope along with the name of the material/work,date of opening.

Both these two sealed covers are to be put in a bigger cover which should also be sealed and marked with the name of the work and date of opening and send to this office. Tenders will be received by the Addl. Director General (E) (SZ), AIR & DD, Chennai- 5 up to **1200 hrs on 21.09.2011** and **technical bid will be opened on the same day at 1500 hrs**. The opening date for financial bid will be intimated latter after technical evaluation of Technical Bids.

2. **VALIDITY:-** The tender shall be kept valid for three months from the date of opening.
3. **PRICES:-** : The prices quoted should be firm and for free delivery at site inclusive of transit insurance, excise duty and entry tax and other taxes if any. Tenders should quote in figures as well as in words the amounts tendered by them. In the case of illiterates, the rates or the amounts tendered should be attested by a witness.

4. DUTIES AND TAXES:-

- i) **EXCISE DUTY:-** The prices should contain an element of Excise Duty which should be indicated separately. Any statutory variation in the excise duty taking place after acceptance of tender within the delivery date will be adjusted by the purchaser on production of documentary proof.

ii) SALES TAX/VAT:

The prices should be exclusive of ST/CST/VAT. The prevailing rate of ST/CST/VAT should be clearly mentioned in the tender.. The following certificate is to be submitted by the supplier along with the bills.

“Certified that the goods on which the sales tax has been charged have not been exempted under central sales tax act of the rules made there under. The amount charged on account of Sales Tax/VAT on these goods is not more than what is payable under provision of the relevant act or the rules made there under”.

“Certified that we are registered as dealers in the State under registration No.for the purpose of Sales Tax. Any Statutory variation in ST/CST taking place after acceptance of tender within the delivery date will be adjusted by the purchaser.

(C) **WORKS CONTRACT:-** If work contract tax is leviable by the concerned State Govt.on works contracts, the same shall be clearly mentioned in the tender.

5 TERMS OF DELIVERY:- F.O.R. Destination. **PARVATHI PURAM, VIZIANAGARAM -DIST. ANDHRA PRADESH.**

- 6 **DELIVERY PERIOD:-** Tenderers may note that the entire work shall be completed Within **50 days** from the date of the work order. The lay out wirings and other drawings wherever applicable shall be got approved within 7 days from the date of Work order.

- 7 **EARNEST MONEY DEPOSIT:** Earnest Money amounting **Rs.20,000/-** in the form of Demand Draft on a Nationalised Bank drawn in favour of Addl.Director General(E)(SZ), AIR & Doordarshan, Chennai-5 should accompany the tender as part-I as mentioned in Clause-22. Submission of tender. EM.D. by means of Bank guarantee or any other mode of payment other than DD shall not be accepted. Tenders without EMD shall be summarily rejected and their technical cum commercial bid will not be opened at all at the time of tender opening.

EMD of all but the last three tenderers will be returned back within 10 days of opening of tenders. EMD of the remaining two tenderers other than that of the successful tenderer will be returned after finalizing the contract. EMD of the successful tenderer will be returned after submission of Security Deposit.

8. IT CLEARANCE CERTIFICATE:-

Income tax clearance certificate and PAN Number shall be submitted along with the tender, without which the tender is liable to be rejected.

9. **EXPERIENCE:** The tenderer should give documentary proof for having successfully designed. Fabricated, Installed and Commissioned similar type of equipment/work. They should also submit list of works which are in hand at the time of submission of tender. The list shall contain the name of work, cost of work and present position of work.

- 10. AFTER SALES SERVICE:-** Tenderer should give full details of after sales service capability. The locations of service centers across the country shall be indicated. If there are no service centers at/ near the location of the site the tender is likely to be rejected.
- 12. TECHNICAL SPECIFICATION AND GENERAL TERMS AND CONDITIONS:-**
For technical specification See the Annexures -1, for Drawing see **Annexure-II** and for other general terms and conditions see Annexure-III.
- 13. ACCEPTANCE/REJECTION OF TENDER:-** The acceptance of a tender will rest with the Chief Engineer(South Zone), AIR & Doordarshan, Chennai-5 who does not bind himself to accept the lowest tender and reserves to himself the authority to reject any or all of the tenders received without assigning any reason
- 14. GENERAL:-** 1.Canvassing in connection with tender is strictly prohibited and the tenders submitted by tenderness who resort to canvassing will be rejected.
2. If any tenderer want to inspect the site and quote may do so after getting prior permission form Deputy Director(E),Doordarshan Maintenance Centre, Visakapatnam(AP)

(C.MOOKAN)
Director (E)
For Addl.DG(Engg)(SZ)

Encl:-

- 1. Technical Specifications, Annexure-1.**
- 2. Generals terms and conditions, Annexure-II**
- 3. Drawings, Annexure III**

TECHNICAL SPECIFICATIONS

Supply, Installation, Testing and Commissioning of Pre-fabricated Porta Cabin of size **7 Mtr X 4 Mtr X 3.5 Mtr** at **VLPT, Parvathipuram of AP State** as per the attached drawing specification as detailed below :

1.. The Porta Cabin is to be made of pre insulated sandwich panels having properties like density, compressive, tensile strength, structural, water absorption properties and hot dimensional stability, cold dimensional stability, thermal conductivity, etc, as certified by Central Institute of Plastics Engineering and technology, Government of India. Guindy, Chennai.

2.The Porta cabin has to be mounted on a cement platform of 3 feet (2 ft inside from the ground level and 1ft above the ground level) constructing necessary concrete pillars. The concrete pillars (1 ft X 1ft) should be equally distributed at an interval of 1 meter for the entire area of Porta Cabin structure. The entire area of concrete pillars should be brick walled. The gap between the porta cabin base and the ground to be filled with sand and blue metal and should be firmly packed before finishing it for final cement concrete flooring. The packing should be cured fully so as to withstand the load of the porta cabin.

3.The basic steel frame should be strong enough to support the structure and the steel structure to be strengthened in places where some heavy units like Power distribution panels that are mounted with the vertical support of the wall.

4. The outer walls should be made up of SMC(sheet moulding compound) depression panels of pyramid shape modular type as per IS 10192 capable of withstanding pressure of 180Kmph,manufactured by hot compression moulding process of size 1MX1M with fire retardant as per UL-94 Standard.

5. It should be shock proof, resistant to saline and chemical nature and having thermal insulation properties with flange of 75 mm having minimum thickness of 9 mm on all four sides. The panel depression will be of minimum thickness 2.5 mm. The panels shall have predrilled on the flange area. The panels are to be joined together using EPDM BUTYL Rubber Gas/PVC Foam Gaskets(75 mm Width and 2.5MM Thick).

6. The panels are to be assembled using M 10X40 SS fasteners. 3 nos per flange Polyurethane coating shall be given to the outer walls of the panels.

7. Inner wall paneling should be of Polymeric panels of minimum 6mm thickness, width and air gap of minimum 4mm and the panels joint together by tongue and groove using self tapping screws.

8. Polyurethane coating should be given to the outer shell of the SMC Shelter.The Shelter should be weather proof, Resistant to chemical and saline nature, Shock proof, Fire retardant and Maintenance free.

9. The ceramic tiled flooring should be provided on the PCC(Plain Cement Concrete) and flooring to be finished neatly.

10. All the rooms except the transmitter hall room should be provided with the ceramic floor tiles of size 1 feet X 1 feet of reputed make. PVC rolls of 2mm thickness of reputed -

make like wonder floor, ocean blue colour to be provided in the transmitter hall. The firm has to consult the Installation Officer to select the colour / brand of the floor files.

11. Partition frames to be made up of anti corrosive painted 25 mm square tubular section and double side paneling with polymeric section of minimum 6 mm with an air gap of minimum 4mm and these panels joined together by tongue and groove self tapping screws. Doors for the partitions should be polymeric doors with sliding type arrangement.

12.Doors: Doors should be of SMC hot compression moulded with suitable hinges, handle and two pad locks front side and rear side respectively. Size 2M X1M with rubber bulb bedding for air-tight closure of doors. Puff insulation of minimum density 38 Kg/Cu.m. polyurethane foam should be injected in to the cavity of the above SMC panels on the walls and 25 mm thick and minimum density of 38 Kg/Cu.m .Polyurethane foam sheets in between partition paneling for better thermal insulation.

13.Windows:Windows should be of Polymeric frame of size 120mmx90 mm with open type doors of glass with suitable thickness of 5 mm. The windows should have steel grills. All the windows and front door should be provided with proper sunshade. Size of the sun shade should be sufficient ,enough to serve the purpose. The design, Size, colour of the paint to be applied on the grill to be got approved from Installation Officer / this office.

14.Observation windows of size 30 mmx30 mm are to be provided in the entry doors of technical areas. Inner wall paneling should be of polymeric panels of minimum 6 mm thick with an air gap of minimum 4 mm and the panels joined together by tongue and groove using self tapping screws.

15. False ceiling frame works made out of anti corrosive painted 25 mm square tubular section designed to be fixed to the above roof truss and walls using M6 Fasteners of suitable length. False ceiling should be done with polymeric section of minimum 6 mm thick with an air gap minimum of 4mm these panels joined together by tongue and groove using self tapping screws. Height of the false ceiling should be 3Mtr. from the floor.

16.Roof truss should be made up of anti corrosive GI corrugaed painted 25 mm square tubular section designed to suit the proof structure with colour coated roof sheet with top plate to be fixed with fasteners to with stand high wind pressure.

17. Suitable rain water harvesting arrangement has to be provided. The whole porta cabin should be supported by pre-fabricated steel structure.

18.Toilet:The toilet should be provided with a Wash basin(Stainless steel),Water Tab, Indian closet, mirror, towel hanger along with plumbing materials. The floor of the toilet should be made of concrete to avoid damage of floor in future. Toilet waste water to be routed outside as per the site requirement. The toilet should be connected to the existing septic tank.

19.Electrical System: The firm has to provide the entire electrical installation including the required wiring, as per the electrical plan attached. The wire/cable used should be of reputed Make of suitable ratings as advised by the installation Officer. The firm has to provide lighting points and fan points for all the rooms and carridors. The firm should fix one Three Phase 440V,50 HZ Power Distribution Panel of approx. size of 4 feet X 3 feet. All the materials like MCBs, wires, PVC conduits, necessary switches, etc, which are required to complete the electrical installation as per the attached electrical plan should be included in the offer. Cutouts should be made where necessary for electrical fittings, exhaust fans. All the rooms should be properly illuminated including passage.

Scope of Works/Material

1. Demolishing the old building.(10mx6mx3.5m)
2. Laying of foundation for mounting the Porta cabin as per the technical specifications.
3. Prefabricated Porta cabin of size of 7m x 4m x 3.5 m as per the technical specifications.
4. Plumbing works and materials as mentioned
Including one Wash basin(Stainless steel),Water Tab, Indian closet, mirror, towel hanger along with plumbing materials
5. Flooring works with specifications mentioned
6. False ceiling works with specifications mentioned
7. Rainwater Harvesting
8. Door (size -2mx1m) - 3 Nos with specifications mentioned
9. Windows(size-4 feet x 2 feet) - 4 Nos with specifications mentioned
10. Electrical Works and materials as per Electrical Plan with specifications
Mentioned in the Drawing including Three phase, 440 V, 50HZ Power Distribution Panel- 1 no, Twin tube light with fitting-4 nos, Single tube light with fitting-1 no Fan-3nos, Exhaust fan-2 nos and power supply Cables / wires / switches required thereof.

Actual plan / drawings / electrical plan / material should be submitted by tenderer which will be approved by Zonal Office.

GENERAL TERMS AND CONDITIONS FOR WORK ORDER

1. NAME OF PURCHASER : The President of India
2. PAYING AUTHORITY : The ADDL. DIRECTOR GENERAL (E)(SZ)
All India Radio & Doordarshan
Swami Sivananda Salai,
Chennai-600 005.

3. **PAYMENT TERMS:**

- (i) 80 % of the material cost inclusive of excise duty and sales tax will be paid on Delivery/receipt of the material in good condition at the site.
- ii) 20% of Installation cost of portacabin and 100% of installation cost will be paid on satisfactory completion and handing over of the structure in good condition in all respect to the department.

4. **BILLS:**

All the supplies and works shall be in conformity with the order and the entire part bill shall be prepared in quadruplicate in the same format as that of the order. All those part bills shall be submitted to the consignee for necessary certificates and Onward transmission to the paying authority.

5. **SECURITY DEPOSIT:**

The contractor shall furnish the security deposit with in 2 weeks of placement **of order at the rate of 10 % of the contract value subject to a maximum of Rs. 5 Lakhs at the time of signing the contract.**

The security deposit shall be furnished in favour of “The Addl. Director General (E) (South Zone), AIR & TV,Chennai-5” in any one of the forms mentioned below.

- a) Cash in full (b) DD Payable at Chennai (c) Post Office/National savings Certificates d) Terms deposits in any nationalized bank e) Bank Guarantee from any Nationalized Bank valid upto the end of warranty period as per contract

The EMD received will be returned after receipt of S.D. The security Deposit shall be refunded in full on completion of successful guarantee/ Warranty.

6. **DESPATCH INSTRUCTIONS:**

The packing and marking of goods shall be as laid down in clause-12 of general conditions of contract DGS & D 69 (Revised).

- a) The contractor shall arrange to dispatch the goods duly insured direct to the consignee after prior intimation for delivery at site by whichever mode of transport he may choose, to ensure safe delivery of goods at site. un loading shall be done at site at the contractor’s Expense. Only storage space will be provided by the consignee. The contractor will provide his own security like locking etc and store the materials at his own risk.

b) The contractor must submit his challans in triplicate to the consignee sufficiently in advance of the actual arrival of the stores at the destination failing which he will be held responsible for any subsequent discrepancies between the actual receipt and the material detailed in the challan received later. The challan must also contain the following information:

1. Brief description of stores.
2. Railway/ Lorry Receipt No. & Date.
3. A/T No. & Date.
4. Inspection note No. & Date

c) The consignment received at site shall be opened and checked for shortages/damages by the contractor himself. He shall show all the materials received at site to the consignee to enable him to certify receipt of stores in good condition. However, in exceptional circumstances, the contractor may request the consignee to check the consignment on his behalf. In such cases the consignee shall notify the contractor of the shortage/damages immediately on receipt of consignment at site. Expenses incurred, if any, in checking the consignments shall be debitable to the contractor's account.

7. INSPECTION:

a) SCOPE OF INSPECTION:

i) **PRE INSPECTION:** Manufacturers / Contractors must satisfy themselves that the stores are in accordance with the terms of the contract and fully conform to the required specification by carrying out thorough pre-inspection of each lot before actually tendering the same for inspection to the inspecting officer nominated under the terms of the contract. A declaration by the contractor that the necessary pre-inspection has been carried out on the stores tendered shall be submitting along with the challan. The declaration will also indicate the method followed in carrying out pre-inspection showing the features checked, tested and will have the certificates attached to the challan/declaration. If the Inspecting officer finds that pre-inspection of the consignment' as required above has not been carried out the consignment is liable for rejection.

ii) **INITIAL INSPECTION:** All the supplies including fabricated items and bought out items shall be inspected before actual inspection. The place of inspection shall be as at below. Also the installation at the site shall be inspected periodically during installation. If the inspecting officer finds initial inspection that the supplies are not according to specification, the suppliers is liable for rejection. The purchaser may at his discretion waive initial inspection in respect of those supplies which bear ISI certificates or manufacturer's test certificates. The contract shall approach the inspecting officer for inspection at least two weeks in advance of the actual date of inspection. All arrangements for inspection shall be made by the contractor. Any deviation in stores after initial acceptance by the Inspector and their receipt by the consignee shall be to the account of the contractor. The contractor shall forward the relevant copies of the inspection certificates of the stores to the consignee along with delivery challan.

iii) **FINAL INSPECTION:**

The entire installation shall be inspected by the inspecting officer on completion of Installation, commissioning, testing and commissioning at site.

b) INSPECTING OFFICER: Consignee or Nominees of the Addl. Director General (E)(SZ).

c) PLACE OF INSPECTION:

- I) Fabricated items at Contractors factory.
- II) Bought out items at Suppliers works or at projects site.

8. INSURANCE:-

The contractor shall arrange for the insurance covering the risk during transit, Storage and installation till commissioning. All the charges for such insurance shall be borne by the contractor.

9. ADDITIONAL QUANTITIES:-

The purchaser reserves the right to place order for additional quantity upto 100% of the ordered quantity at the same rates and terms and condition during the currency of the contract.

10. PENALTY FOR DELAY:-

If the contractor is unable to complete the supply, installation, testing and commissioning within the stipulated time limit the purchaser may at his option allow such additional time as may be considered justified with/without penalty and without altering terms and conditions of the order. In the event of failure of the contractor to complete the supply, installation testing and handing over the porta cabin within the stipulated time or the extended time, the purchaser has the right to impose penalty of Rs.350/- per week or part thereof for every Rs.1,00,000/- of the total contract price. The contractor's liability for delay, however, shall not exceed 5% of the total contract price.

11. GUARANTEE / WARRANTY:-

The contractor shall accept clause-18 of the Form No. DGS & D-71 with exception that his obligation shall be limited **for a period of 12 months from the date of taking over Completion of the successful performance excluding down time during which the equipment was not working satisfactorily due to defective parts, faulty material/design/workmanship or fault erection.** During the guarantee period the contractor shall repair or replace free of charge any parts that will become defective due to faulty material design, workmanship or erection.

12. CONDITIONS OF CONTRACT:-

DGS & D-68 (Revised and DGS & D-71 as amended upto date. However, Such of these conditions stipulated on this tender shall supercede corresponding conditions in DGS & D-71.

The contractor shall sign a contract agreement form in triplicate in the prescribed Proforma and submit the same alongwith Security Deposit within 15 days. The complete form with the purchaser's signature shall be sent back to the contractor. No supplies will be made and no work shall start unless the agreement is signed by the contractor and the purchaser.

13. SPECIAL CONDITIONS:-

In addition to the terms and conditions contained in the general conditions of contract DGS & D-68 (Revised and DGS & D-71, the contract would also be governed by the following special conditions:-

- (a) In case where only a portion of the stores ordered is tendered for inspection at the fag end of the delivery period the purchaser reserves the right to cancel the balance quantity not found acceptable after carrying out the inspection at the risk and expense of the contractor. If however, the stores tendered for inspection are found acceptable the purchaser may grant an extension of the delivery period subject to the following conditions:-

- (b) That no increase in price on account of any statutory increase in or fresh imposition of customs duty, excise duty, sales tax or on account of any other tax or duty leviable in respect of the stores specified in the acceptance of tender shall be admissible on such of the stores as are delivered after the expiry of the delivery period stipulated in the A/T.
- (c) That notwithstanding any stipulation in the contract for increase in price or any other grounds no such increase which takes place after the date of delivery stipulated in the A/T. shall be admissible on such of the stores as are ordered after the expiry of the delivery period stipulated in the A/T.
- (d) But, nevertheless the purchaser shall be entitled to the benefit of any decrease in price on account of reduction in or remission of customs duty, excise duty, sales tax on account of any other ground stipulated in the price of variation clause which takes place after the expiry of the date of delivery stipulated in the A/T.
- (e) The contractor shall not dispatch the stores till such time extension in delivery period is granted by the purchaser and accepted by the supplier before and extension letter as aforesaid is issued by the purchaser, the same are deemed to be subject to the conditions set out in preceding paragraph.
- ii) In case where the entire quantity has not been tendered for inspection within the delivery period stipulated in the A/T and the purchaser chooses to grant and extension of delivery period, the same would be subject to conditions mentioned in (i) above.
- iii) The contractor shall refund any advance/part payment issued to him in respect of the rejected stores within 14 days of the receipt of intimation from the consignee about the rejection of such prices. This is strictly without prejudice and in addition to the rights provided in the clause-17(8) of form DGS & D-67.
- iv) The contractor is required to replace the rejected stores forthwith but in any event not later than a period of 14 days from the date of rejection and the contractor shall bear all the costs of such replacement including freight, if any but without being entitled to any extra payment or any other account.
- v) Where under the contract, price payable is fixed F.O.R. dispatching station, the contractor shall, if the stores are rejected at destination by the Consignee, be able to, in addition to his other liabilities (including refund of price recoverable in respect of the stores rejected) to reimburse to the purchaser the freight and all other expenses incurred by the purchaser in this regard.

14. ENFORCEMENT OF LABOUR LAWS:-

While engaging labour for carrying out obligations under the contract the contractor shall satisfy the conditions laid down under contract labour (Regulation and Audition) Act 1970 and (Central) Rules 1971 as amended from time to time and observe all formalities required as per said Act/Rules. The supplier shall also observe the provision under minimum wages act 1948 (Central) Rules 1950 amended from time to time while engaging labour.

15. FORCE MAJURE:-

If any time during the continuance of the contract the performance in whole or in part by the contractor shall be prevented or delayed by reason of any war, hostility acts of the public enemy. Civil commotion, Sabotage, fires, floods, explosions, epidemics, Guarantee restrictions, strikes, lock-outs or acts of God (therein after restrictions refer to as events and provided notice of happenings of any such eventuality is given by the contractor within 21 days from the date of occurrence thereof, the purchaser shall by reason of such event, neither be entitled to cancel this

order not shall have any claim for damages against the contractor in respect of such non-performance or delay in performance and delivery shall be resumed as soon and practicable after such events have come to an end or ceased to exist.

Provided further that if the performance in whole or part or any obligation under this order is prevented or delayed by reasons of any such event for a period exceeding 180 days, the purchaser and the contractor shall meet to find a natural agreement to any effect resulting the reform or the purchaser may at his option cancel order provided also that if the order is cancel the order provided also that if the order is cancelled under this clause, the purchaser shall be at liberty to take over from the contractor at order prices all unused, un-damaged and acceptable material bought out components and stores in course of manufacture in the possession of the supplier at the time of such cancellation or such portion thereof as the purchaser may deem fit accepting such material, bought out components and stores as the supplier may with the concurrence of the purchaser elect to retain.

16. TECHNICAL MANUALS & DRAWINGS

Contractor shall furnish six copies of comprehensive technical manuals for use by the operation staff. Such manuals shall contain instructions from the preventive as well as routine maintenance of the plant. The contractor shall also furnish copies of approved wiring diagrams, schematics, etc., for various items equipment.

17. CANCELLATION:

The purchaser reserves the right to cancel the order in the event of non-performance or unsatisfactory performance by the contractor and recover payment already made if any, along with losses/damages incurred.

(C.MOOKAN)
Director (E)
For Addl.DG(Engg)(SZ)

Annexure - III

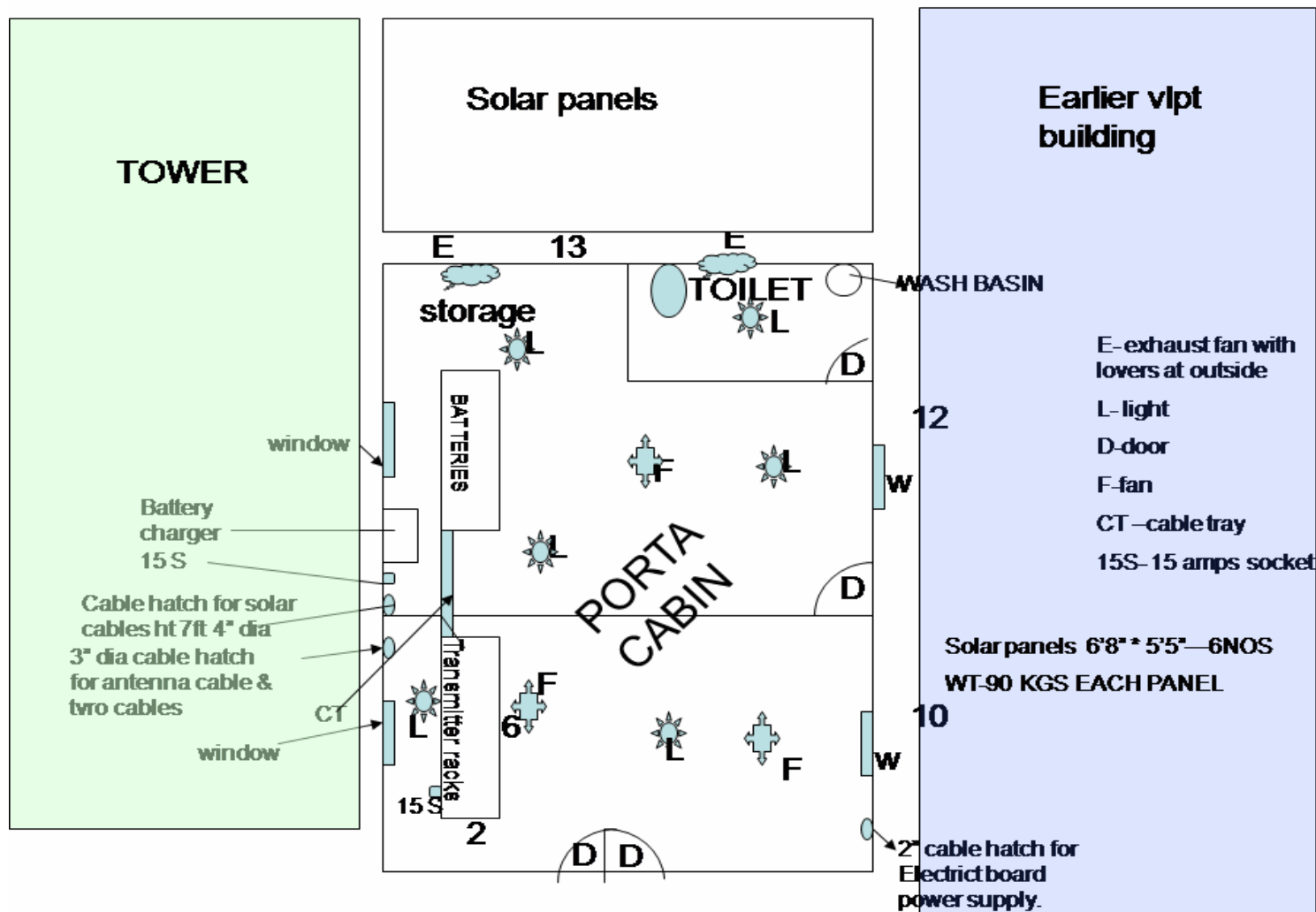

VLPT Parvathipuram Porta cabin

tentative diagram

REAR

REAR

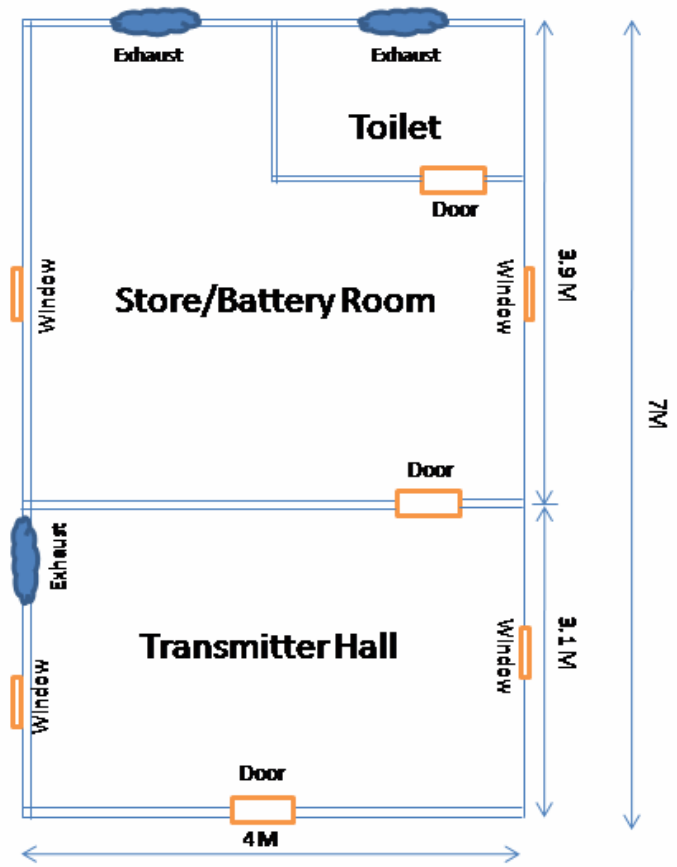

FRONT CIVIL PLAN

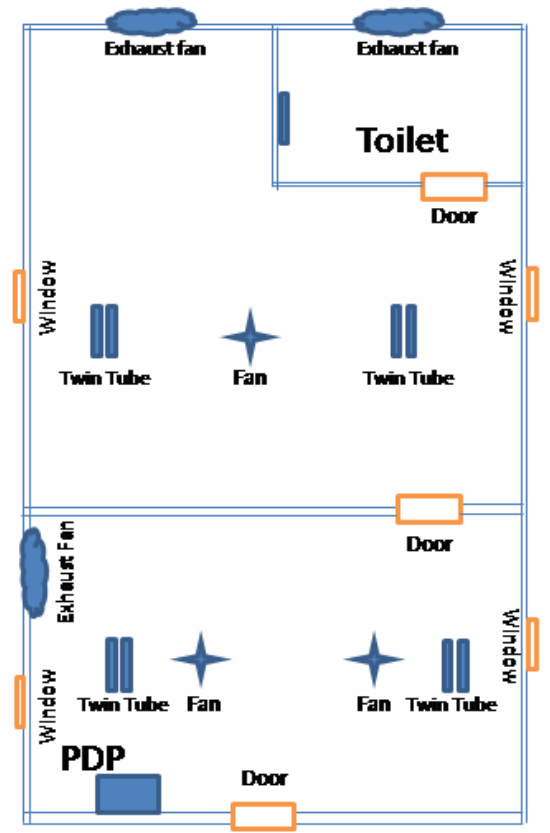

FRONT ELECTRICAL PLAN

VLPT Parvathipuram Porta cabin tentative diagram

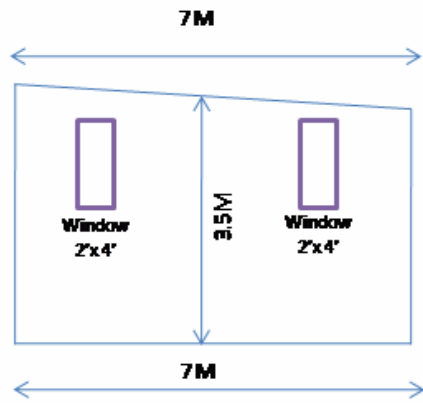

SIDE VIEW 1

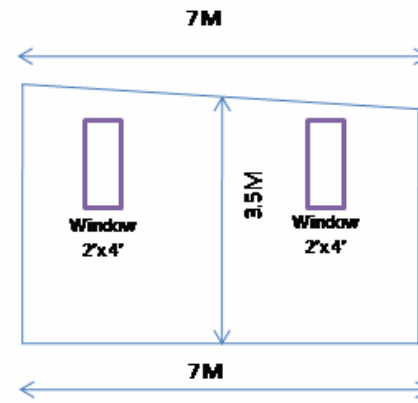

SIDE VIEW 2

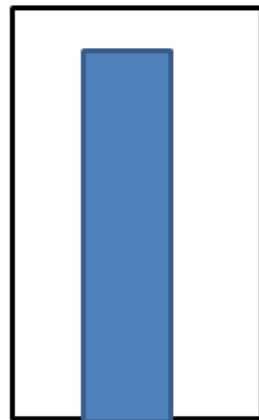

FRONT VIEW

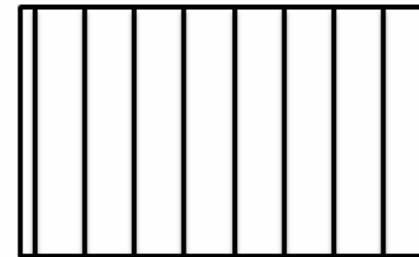

ROOF PLAN